

SHERMAN COUNTY SPROUTS CHILD DEVELOPMENT CENTER

INFORMATION & INVESTMENT OPPORTUNITIES



THE FUTURE GROWS HERE.



TOGETHER WE ARE INVESTING IN THE GROWTH,
DEVELOPMENT, AND FUTURE OF SHERMAN COUNTY.

SHERMANCOUNTYSPROUTS.INFOCAMPAIGN.ORG

Sherman County Sprouts is a child care initiative, focused on increasing child care capacity, providing support to local providers, and ensuring quality care in Sherman County.

From an economic development standpoint, the birth to age 5 child care capacity issue is a barrier for businesses looking to maintain and hire staff. From the parent's position, it is the tough decisions that all too often result in one of them leaving the workforce. From a community perspective, child care is a necessity to attract and keep young families in the area. This long-time issue of capacity constraints was made more apparent by the pandemic, resulting in public awareness and the dire need to find a solution to keep our rural community thriving.

First steps included building a team of individuals with a common goal and vision of the work that needs to be done. We approached various entities throughout our area and built a very solid team with diverse backgrounds and areas of expertise. On our team we have business owners/managers, early childhood development professionals, local government employees, current child care providers, school administrators and teachers, Central Nebraska Community Action Partnership representatives, Chamber of Commerce and Economic Development board members, Sherman County Community Foundation representatives, legal counsel, financial experts, parents, grandparents, and invested community members. We successfully formed a non-profit 501(c)3 "Sherman County Sprouts, Inc." to oversee the child care center project now, and well into the future, as our motto says: "The Future Grows Here".

From birth to age five, a child's brain develops more rapidly than at any other time in life.



A building in downtown Loup City, that had previously housed the Sherman County Prevention Coalition After School Program, was offered up for sale when the owners heard that we were looking for a space to open an early childhood development center. Cognizant of the need, the County Commissioners then helped us jump on that opportunity by allocating a portion of their ARPA (American Rescue Plan Act) Funds to purchase the building and adjoining lot. The property was then gifted to Sherman County Economic Development to renovate the existing 3,000 square foot building into a child care facility, with the potential for a Phase 2 Expansion on the open adjacent lot if the capacity gap still exists once operational. Our team is working with The Lund Company (Omaha, NE) for project management and advisory services; as well as Wilkins Architecture Design Planning (Kearney, NE) for the layout, design, and renovation execution. Everyone is eager to get Phase 1 in motion as we kick off our capital campaign to secure funds to begin the construction work. The current building would have a capacity between 25-30 children, which would more than double what is available for licensed slots currently.



“We can't grow a community, increase jobs, and build housing without improving child care disparities. Young families with children can't move here, or stay here, if there are not quality child care services available.

-Local Business Owner
Survey Response

”

SHERMAN COUNTY STATISTICS

In cooperation with Communities for Kids, a Sherman County Early Childhood Care Survey was conducted in June of 2022.

Do you think there are enough child care options in the community?

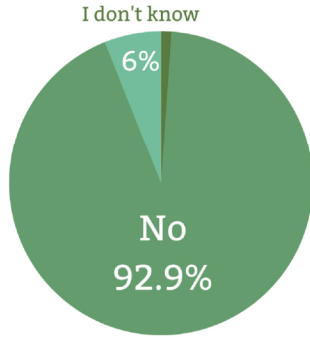

Of the Survey Respondents, 40 Families with Children Ages 0-5 are Currently Looking for Child Care in Sherman County. 30 Are Currently Using Services.

Quality Child Care Availability

Number of children under age 6 with all available parents working	113
Total number of licensed childcare spots 75% of total full time capacity	20
50% of the 48 in Head Start/Preschool	24
Number of children under age 6 not enrolled in a private licensed child care provider or public preschool	69

Gap of Available Childcare Options

Was it difficult to find child care locally?

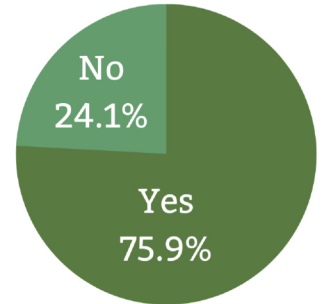

Number of Licensed Child Care Providers Currently operating in Sherman County:

2

Looking for Child Care



Using Services

ECONOMIC IMPACT OF A CAPACITY GAP:

A Gap of 69 Children Without Stable Child Care Options Ensues an Estimated **\$1 Million** Loss Annually in Sherman County.

According to:
www.childcaregap.org

Household Impacts: Income losses parents incur from having to reduce their work hours or leave the labor force entirely, as well as future lost earnings from delayed opportunities for promotions, reduced work experience, and reentering the workforce at a lower station.

Business Impacts: Direct productivity losses, such as hours of foregone worker productivity and continual pay and benefits paid to employees when they are not working, as well as future lost earnings from turnover costs and the delayed ability to capitalize on growth opportunities.

Tax Revenue Impacts: The proportion of lost household and business income that would have contributed to government revenues, as well as future lost tax revenues from future lost household and business earnings.



If an early childhood center-based program were to be developed in our community, would you support it?

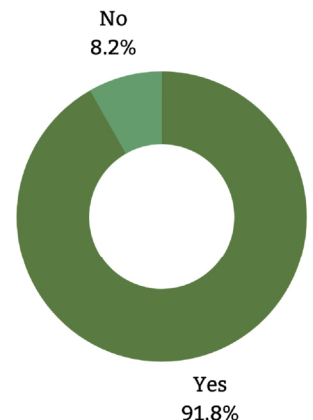

CHILD CARE CENTER RENOVATION + START-UP BUDGET

Acquisition + Construction/Renovation	Survey, Insurance, Earthwork, Landscape, Utilities, Exterior Renovations, New Roof, Interior Renovations: Classrooms, Office, Vestibule, Restrooms, Laundry, Corridors, Kitchen, Mechanical Upgrades, Fire System, New Electrical Gear, Permits & Fees	\$525,000
Architecture, Engineering, Design Provided by Wilkins Architecture Design Planning LLC of Kearney	Preliminary Planning & Assessments, Architecture/Building Engineering, Civil Engineering, Interior Design, Kitchen Design, IT Design, Outdoor Play Equipment Design, Special Inspections, Fundraising Campaign Website Design	\$50,000
Project Administration Provided by The Lund Company	Project Management Services, Legal, Accounting, Marketing/Fundraise Support, General Liability Insurance, Consultant Travel + Printing	\$25,000
Furnishings, Fixtures, Equipment	Classroom Furniture, Classroom Manipulatives, Non-Classroom Furniture, Network Equipment, Computers, Audio/Video Systems, Security System, Telecom Service, Laundry Equipment, Breakroom Appliances, Kitchen Equipment, Playground Equipment, Signage, Operating Supplies & Equipment	\$100,000

Total Renovation Cost: \$700,000

Business Start-Up	Licensing & Regulatory, Professional Development/Staffing, First Year Start-Up Expenses, Operating Capital (2 Years)	\$300,000
Scholarship Assistance	Fund Available for Families in Need to Apply for Assistance + Will also accept State Aide for Families that Qualify	\$100,000

Total Start-Up & Sustainability Plan: \$400,000

All figures are estimates, final numbers may vary.

Phase 1



Potential Phase 2



Capital
Campaign
Goal:
\$1.1 Million

Planting a solid foundation for future growth.

The campaign goal is taking into account the costs to renovate the facility and ensure long term sustainability by allocating funds for startup costs, workforce training, scholarships for families in need, operating expenses, and future growth opportunities.

DONOR WALL RECOGNITION

Gifts of \$1,000 or greater will be recognized collectively on a donor wall according to the following level and will be prominently displayed in the facility.
Also consider giving In-Kind Donations of Time, Labor, or Resources.



Donor Tiers

Gift of \$1,000 - \$2,499 – Generous Green Thumb

Gift of \$2,500 - \$4,999 – Cultivators of Creativity

Gift of \$5,000 - \$9,999 – Helping Young Minds GROW

Gift of \$10,000 – \$19,999 – The Giving Tree

Gift of \$20,000 - \$49,999 – Bountiful Harvest

Gifts Over \$50,000 - Master Gardener

A FEW OF OUR CURRENT PARTNERS:



Local & State Entities coming together to help 'Sherman County Sprouts' grow.



CURRENT SHERMAN COUNTY SPROUTS

BOARD OF DIRECTORS:

Stephanie Friesen, Melissa Dush, Deb Obermiller, Sasha Habe, & Christy Hruza.

Not Pictured: Dean Tickle & Clayton Suckstorf

In June of 2022, Sherman County was officially accepted as a "Communities for Kids" community. With that acceptance, our project was awarded \$52,000 in grant contracts to propel our project through the planning phase and support our local child care providers with grants.



Communities for Kids
nebraskachildren



**CREATION &
MANAGEMENT OF
A LOCAL CHILD
CARE CENTER**



**SUPPORT & GRANTS
FOR LOCAL CHILD
CARE PROVIDERS**



**ENSURING
QUALITY CARE**

FUTURE SHERMAN COUNTY SPROUTS CHILD DEVELOPMENT CENTER 120 NORTH 6TH STREET - LOUP CITY, NEBRASKA



6 WEEKS - 18 MONTHS
Sweet Peas
Ratio - 4:1

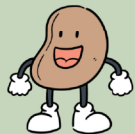

18 MONTHS - 3 YEARS
Jumping Beans
Ratio - 6:1



3 YEARS
Talkative Tomatoes
Ratio - 10:1



4 YEARS - 5 YEARS
Clever Carrots
Ratio - 12:1

STATE LICENSE REQUIRED CHILD : TEACHER RATIOS

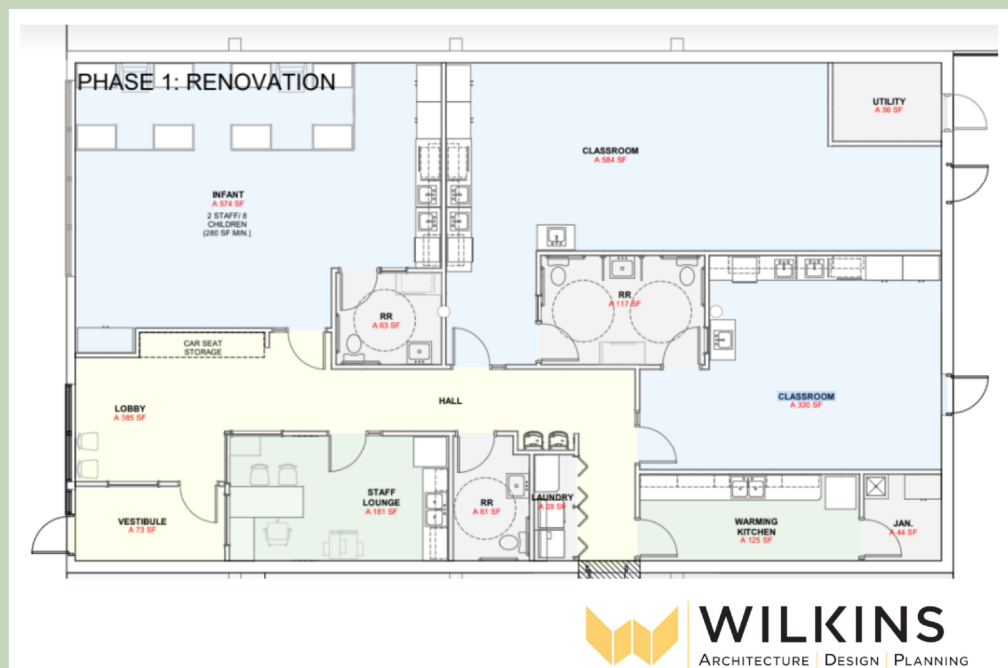

MAKE CHECKS PAYABLE TO:
SHERMAN COUNTY SPROUTS
P.O. BOX 428
LOUP CITY, NE 68853

QUESTIONS?
CONTACT MELISSA DUSH
308-745-5040
INFO@SCEDINC.ORG

MORE INFORMATION CAN BE FOUND ON OUR WEBSITE:
SHERMANCOUNTYSPROUTS.INFOCAMPAIGN.ORG

SHERMAN COUNTY SPROUTS, INC. IS A 501(C)3 NON-PROFIT ORGANIZATION AND DONATIONS ARE 100% TAX DEDUCTIBLE. DONATION RECEIPTS AVAILABLE UPON REQUEST.